

PROJECT 10073 RECORD CARD

1. DATE 17 Mar 62	2. LOCATION E Orange, NJ.		12. CONCLUSIONS <input type="checkbox"/> Was Balloon <input type="checkbox"/> Probably Balloon <input type="checkbox"/> Possibly Balloon
3. DATE-TIME GROUP Local _____ GMT 17/2335Z	4. TYPE OF OBSERVATION <input type="checkbox"/> Ground-Visual <input type="checkbox"/> Ground-Radar <input type="checkbox"/> Air-Visual <input type="checkbox"/> Air-Intercept Radar		<input type="checkbox"/> Was Aircraft <input type="checkbox"/> Probably Aircraft <input type="checkbox"/> Possibly Aircraft
5. PHOTOS <input type="checkbox"/> Yes <input type="checkbox"/> No	6. SOURCE Civilian		<input type="checkbox"/> Was Astronomical <input type="checkbox"/> Probably Astronomical <input type="checkbox"/> Possibly Astronomical
7. LENGTH OF OBSERVATION 3 min	8. NUMBER OF OBJECTS 9	9. COURSE SW	<input type="checkbox"/> Other _____ <input type="checkbox"/> Insufficient Data for Evaluation <input type="checkbox"/> Unknown
10. BRIEF SUMMARY OF SIGHTING 10 yr old heard noise looked up. Objt appeared as light. Moved in straight path fm NE to SW. Faded fm sight in 3 min. Looked around some more and saw 3 other lights. Bright night with full moon.		11. COMMENTS Duration of observation and flight characteristics indicate possible a/c sighting.	

34. What were the weather conditions at the time you saw the object?

CLOUDS (Circle One)

- a. Clear sky  
 b. Hazy  
 c. Scattered clouds  
 d. Thick or heavy clouds

WEATHER (Circle One)

- a. Dry  
 b. Fog, mist, or light rain  
 c. Moderate or heavy rain  
 d. Snow  
 e. Don't remember

35. When and to whom did you report that you had seen the object?

18 March 1962  
 Day Month Year

To the Air Force

36. Was anyone else with you at the time you saw the object?

(Circle One)  Yes No

36.1 IF you answered YES, did they see the object too?

(Circle One)  Yes No

36.2 Please list their names and addresses:

  
 East Orange, N.J.

37. Was this the first time that you had seen an object or objects like this?

(Circle One)  Yes No

37.1 IF you answered NO, then when, where, and under what circumstances did you see other ones?

\_\_\_\_\_  
 \_\_\_\_\_  
 \_\_\_\_\_  
 \_\_\_\_\_

38. In your opinion what do you think the object was and what might have caused it?

Don't know

39. Do you think you can estimate the speed of the object?

(Circle One) Yes  No

IF you answered YES, then what speed would you estimate? \_\_\_\_\_

40. Do you think you can estimate how far away from you the object was?

(Circle One) Yes  No

IF you answered YES, then how far away would you say it was? \_\_\_\_\_

41. Please give the following information about yourself:

NAME \_\_\_\_\_  
Last Name First Name Middle Name

ADDRESS \_\_\_\_\_  
St East Orange N.J.  
City Zone State

TELEPHONE NUMBER \_\_\_\_\_

Age 10 Sex M

Indicate any additional information about yourself, including any education, which might be pertinent.

42. Date you completed this questionnaire: 31 March 1962  
Day Month Year

U.S. AIR FORCE TECHNICAL INFORMATION SHEET  
(SUMMARY DATA)

In order that your information may be filed and coded as accurately as possible, please use the following space to write out a short description of the event that you observed. You may repeat information that you have already given in the questionnaire, and add any further comments, statements, or sketches that you believe are important. Try to present the details of the observation in the order in which they occurred. Additional pages of the same size paper may be attached if they are needed.

NAME

(Please Print)

(Do Not Write in This Space)

CODE:

SIGNATURE

DATE

March 31, 1962

The information on this form plus the information in our first letter covers all the information and facts.

[REDACTED]  
East Orange, N.J.  
March 17, 1962

Dear Sir,

Last night I observed something in the sky that might be of some interest to you.

At six thirty last night (March 16). I heard a noise high in the sky. As I looked up, I saw a light in the sky that moved across the sky. It moved in a south-westerly direction and was out of sight in approximately four minutes.

After the light disappeared another "object" with six lights came from the direction from which the first light disappeared. This object traveled at a greater speed going from west to east. At a distance and surrounding this object were smoke and bright sparkling flecks.

Sincerely,  
[REDACTED]

Dear Messrs. [REDACTED]

Thank you for your letter of 17 Mar 62. Would you each please complete the enclosed I ID form 164a, ~~and~~ then mail them in the enclosed envelope so we might have an opportunity to assess this sighting.

In case others also saw the same object, would you please have them fill in the additional forms?

Again, thank you

Sincerely

(H)

Enclose an <sup>envelope</sup> addressed envelope  
to Lt Col Friend at FTD

Accomplished by  
Drome slip 3-29-62

U.S. AIR FORCE TECHNICAL INFORMATION SHEET

This questionnaire has been prepared so that you can give the U.S. Air Force as much information as possible concerning the unidentified aerial phenomenon that you have observed. Please try to answer as many questions as you possibly can. The information that you give will be used for research purposes, and will be regarded as confidential material. Your name will not be used in connection with any statements, conclusions, or publications without your permission. We request this personal information so that, if it is deemed necessary, we may contact you for further details.

<p>1. When did you see the object?</p> <p align="center"> <u>17</u>      <u>March</u>      <u>1962</u>  <small>Day                      Month                      Year</small> </p>	<p>2. Time of day: <u>6</u>      <u>35</u>  <small>Hour                      Minutes</small></p> <p>(Circle One):      A.M.      or      <u>P.M.</u></p>		
<p>3. Time Zone: (Circle One):</p> <table style="width:100%; border: none;"> <tr> <td style="width:50%; border: none;"> <ul style="list-style-type: none"> <li>a. <u>Eastern</u></li> <li>b. Central</li> <li>c. Mountain</li> <li>d. Pacific</li> <li>e. Other _____</li> </ul> </td> <td style="width:50%; border: none;"> <p>(Circle One):</p> <ul style="list-style-type: none"> <li>a. <u>Daylight Saving</u></li> <li>b. Standard</li> </ul> </td> </tr> </table>		<ul style="list-style-type: none"> <li>a. <u>Eastern</u></li> <li>b. Central</li> <li>c. Mountain</li> <li>d. Pacific</li> <li>e. Other _____</li> </ul>	<p>(Circle One):</p> <ul style="list-style-type: none"> <li>a. <u>Daylight Saving</u></li> <li>b. Standard</li> </ul>
<ul style="list-style-type: none"> <li>a. <u>Eastern</u></li> <li>b. Central</li> <li>c. Mountain</li> <li>d. Pacific</li> <li>e. Other _____</li> </ul>	<p>(Circle One):</p> <ul style="list-style-type: none"> <li>a. <u>Daylight Saving</u></li> <li>b. Standard</li> </ul>		
<p>4. Where were you when you saw the object?</p> <p> <u>██████████ St.</u>      <u>East Orange</u>      <u>New Jersey</u>  <small>Nearest address                      City or Town                      State or Country</small> </p> <p>Additional remarks: _____</p>			
<p>5. How long was object in sight?      _____      <u>3</u>      _____  <small>Hours                      Minutes                      Seconds</small></p> <p>5.1 How was time in sight determined?</p> <table style="width:100%; border: none;"> <tr> <td style="width:50%; border: none;"> <ul style="list-style-type: none"> <li>a. Certain</li> <li>b. Fairly certain ✓</li> </ul> </td> <td style="width:50%; border: none;"> <ul style="list-style-type: none"> <li>c. Not very sure</li> <li>d. Just a guess</li> </ul> </td> </tr> </table>		<ul style="list-style-type: none"> <li>a. Certain</li> <li>b. Fairly certain ✓</li> </ul>	<ul style="list-style-type: none"> <li>c. Not very sure</li> <li>d. Just a guess</li> </ul>
<ul style="list-style-type: none"> <li>a. Certain</li> <li>b. Fairly certain ✓</li> </ul>	<ul style="list-style-type: none"> <li>c. Not very sure</li> <li>d. Just a guess</li> </ul>		
<p>6. What was the condition of the sky?</p> <table style="width:100%; border: none;"> <tr> <td style="width:50%; border: none;"> <p align="center">DAY</p> <ul style="list-style-type: none"> <li>a. Bright</li> <li>b. Cloudy</li> </ul> </td> <td style="width:50%; border: none;"> <p align="center">NIGHT</p> <ul style="list-style-type: none"> <li>a. <u>Bright</u>      <u>full moon</u></li> <li>b. Cloudy</li> </ul> </td> </tr> </table>		<p align="center">DAY</p> <ul style="list-style-type: none"> <li>a. Bright</li> <li>b. Cloudy</li> </ul>	<p align="center">NIGHT</p> <ul style="list-style-type: none"> <li>a. <u>Bright</u>      <u>full moon</u></li> <li>b. Cloudy</li> </ul>
<p align="center">DAY</p> <ul style="list-style-type: none"> <li>a. Bright</li> <li>b. Cloudy</li> </ul>	<p align="center">NIGHT</p> <ul style="list-style-type: none"> <li>a. <u>Bright</u>      <u>full moon</u></li> <li>b. Cloudy</li> </ul>		
<p>7. IF you saw the object during DAYLIGHT, where was the SUN located as you looked at the object?</p> <p>(Circle One):</p> <table style="width:100%; border: none;"> <tr> <td style="width:50%; border: none;"> <ul style="list-style-type: none"> <li>a. In front of you</li> <li>b. In back of you</li> <li>c. <u>To your right</u></li> </ul> </td> <td style="width:50%; border: none;"> <ul style="list-style-type: none"> <li>d. To your left</li> <li>e. Overhead</li> <li>f. Don't remember</li> </ul> </td> </tr> </table>		<ul style="list-style-type: none"> <li>a. In front of you</li> <li>b. In back of you</li> <li>c. <u>To your right</u></li> </ul>	<ul style="list-style-type: none"> <li>d. To your left</li> <li>e. Overhead</li> <li>f. Don't remember</li> </ul>
<ul style="list-style-type: none"> <li>a. In front of you</li> <li>b. In back of you</li> <li>c. <u>To your right</u></li> </ul>	<ul style="list-style-type: none"> <li>d. To your left</li> <li>e. Overhead</li> <li>f. Don't remember</li> </ul>		

8. IF you saw the object at NIGHT, what did you notice concerning the STARS and MOON?

8.1 STARS (Circle One):

- a. None
- b. A few
- c. Many
- d. Don't remember

8.2 MOON (Circle One):

- a. Bright moonlight
- b. Dull moonlight
- c. No moonlight — pitch dark
- d. Don't remember

9. The object appeared:

- (Circle One): a. As a light    b. Shiny    c. Dark    d. Don't remember

10. If it appeared as a light, was it brighter than the brightest stars?

yes

11. Did the object:

(Circle One for each question)

- |   |            |           |            |
|---|------------|-----------|------------|
| a. Appear to stand still at any time?           | <u>Yes</u> | No        | Don't Know |
| b. Suddenly speed up and rush away at any time? | <u>Yes</u> | No        | Don't Know |
| c. Break up into parts or explode?              | <u>Yes</u> | No        | Don't Know |
| d. Give off smoke?                              | <u>Yes</u> | No        | Don't Know |
| e. Change brightness?                           | Yes        | <u>No</u> | Don't Know |
| f. Change shape?                                | Yes        | <u>No</u> | Don't Know |
| g. Flash or flicker?                            | <u>Yes</u> | No        | Don't Know |
| h. Disappear and reappear?                      | <u>Yes</u> | No        | Don't Know |

12. Did the object move behind something at any time, particularly a cloud?

- (Circle One): Yes No Don't Know. IF you answered YES, then tell what it moved behind: \_\_\_\_\_

13. Did the object move in front of something at any time, particularly a cloud?

- (Circle One): Yes No Don't Know. IF you answered YES, then tell what in front of: \_\_\_\_\_

14. Did the object appear: (Circle One): a. Solid    b. Transparent    c. Vapor    d. Don't Know

15. Did you observe the object through any of the following?

- |                 |     |           |                |            |           |
|-----------------|-----|-----------|----------------|------------|-----------|
| a. Eyeglasses   | Yes | <u>No</u> | e. Binoculars  | Yes        | <u>No</u> |
| b. Sun glasses  | Yes | <u>No</u> | f. Telescope   | <u>Yes</u> | No        |
| c. Windshield   | Yes | <u>No</u> | g. Theodolite  | Yes        | <u>No</u> |
| d. Window glass | Yes | <u>No</u> | h. Other _____ |            |           |



16. Tell in a few words the following things about the object.

- a. Sound crack of a gun or backfire of a car.
- b. Color white and shiny

17. Draw a picture that will show the shape of the object or objects. Label and include in your sketch any details of the object that you saw such as wings, protrusions, etc., and especially exhaust trails or vapor trails. Place an arrow beside the drawing to show the direction the object was moving.

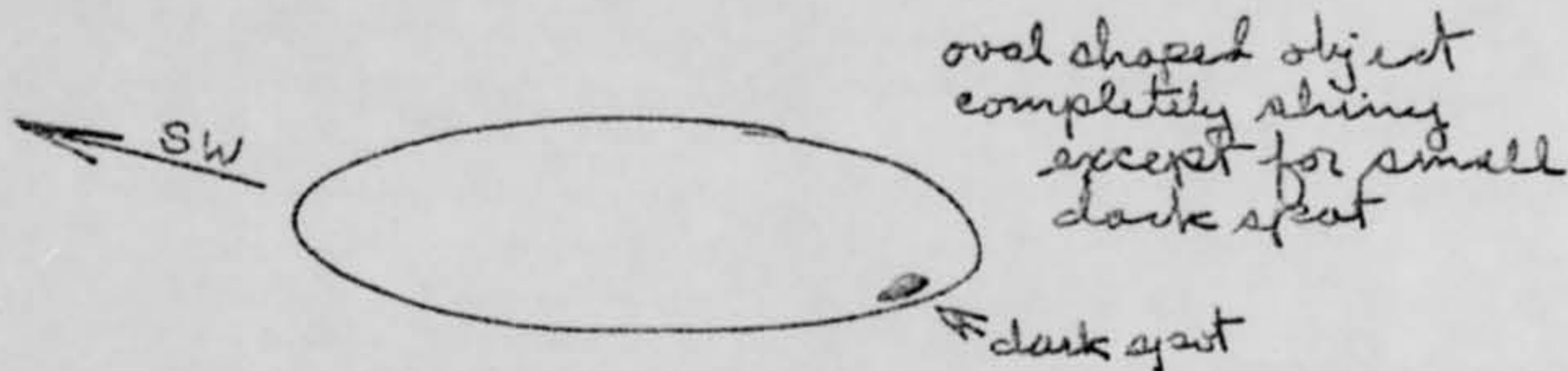

18. The edges of the object were:

- (Circle One): a. Fuzzy or blurred  
 b. Like a bright star  
 c. Sharply outlined  
 d. Don't remember

e. Other \_\_\_\_\_  
 \_\_\_\_\_  
 \_\_\_\_\_

19. IF there was MORE THAN ONE object, then how many were there? Four  
 Draw a picture of how they were arranged, and put an arrow to show the direction that they were traveling.

The "four" objects never appeared together at any given time.

1<sup>st</sup> went from NE to SW

2<sup>nd</sup> appeared in the E and moved in small area

3<sup>rd</sup> appeared in the E more to the S than the second

4<sup>th</sup> appeared in the N

20. Draw a picture that will show the motion that the object or objects made. Place an "A" at the beginning of the path, a "B" at the end of the path, and show any changes in direction during the course.

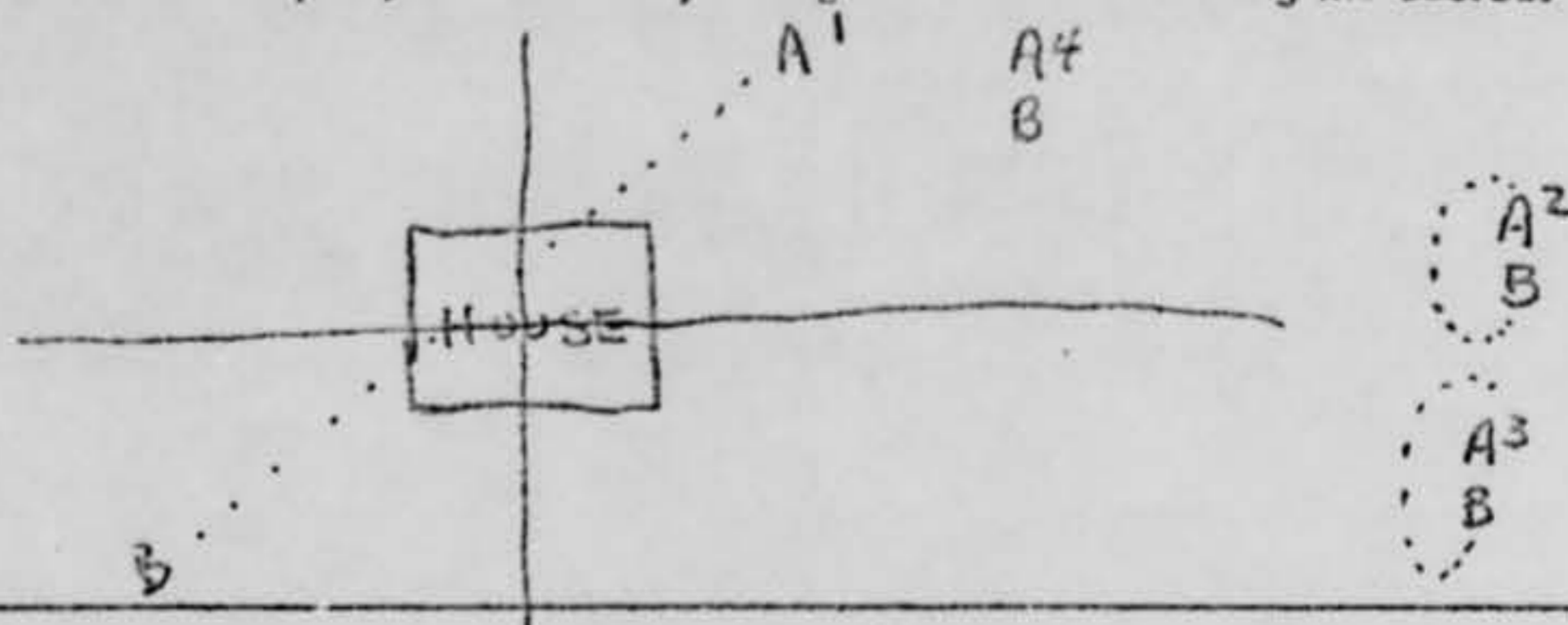

21. How large did the object appear to you as compared to an object with which you are familiar?

*birdcage*

22. We wish to know the angular size. Hold a match stick at arm's length in line with a known object and note how much of the object is covered by the head of the match. If you had performed this experiment at the time of the sighting, how much of the object would have been covered by the match head?

?

23. Did the object disappear while you were watching it? If so, how?

*1st object faded away*

24. In order that you can give as clear a picture as possible of what you saw, describe in your own words a common object or objects which, when placed up in the sky, would give the same appearance as the object which you saw.

*a light bulb without the socket*

25. Where were you located when you saw the object?  
(Circle One):

- a. Inside a building
- b. In a car
- c. Outdoors
- d. In an airplane (type)
- e. At sea
- f. Other \_\_\_\_\_

26. Were you (Circle One)

- a. In the business section of a city?
- b. In the residential section of a city?
- c. In open countryside?
- d. Near an airfield?
- e. Flying over a city?
- f. Flying over open country?
- g. Other \_\_\_\_\_

27. What were you doing at the time you saw the object, and how did you happen to notice it?

It made a noise and we looked up.

28. IF you were MOVING IN AN AUTOMOBILE or other vehicle at the time, then complete the following questions:

28.1 What direction were you moving? (Circle One)

- |              |              |              |              |
|--------------|--------------|--------------|--------------|
| a. North     | c. East      | e. South     | g. West      |
| b. Northeast | d. Southeast | f. Southwest | h. Northwest |

28.2 How fast were you moving? \_\_\_\_\_ miles per hour.

28.3 Did you stop at any time while you were looking at the object?

(Circle One) Yes No

29. What direction were you looking when you first saw the object? (Circle One)

- |                     |              |              |              |
|---------------------|--------------|--------------|--------------|
| a. North            | c. East      | e. South     | g. West      |
| <u>b. Northeast</u> | d. Southeast | f. Southwest | h. Northwest |
|                     |              |              | i. Overhead  |

30. What direction were you looking when you last saw the object? (Circle One)

- |              |              |                     |              |
|--------------|--------------|---------------------|--------------|
| a. North     | c. East      | e. South            | g. West      |
| b. Northeast | d. Southeast | <u>f. Southwest</u> | h. Northwest |
|              |              |                     | i. Overhead  |

31. If you are familiar with bearing terms (angular direction), try to estimate the number of degrees the object was from true North (thru east) and also the number of degrees it was upward from the horizon (elevation).

31.1 When it first appeared:

- a. From true North \_\_\_\_\_ degrees.
- b. From horizon \_\_\_\_\_ degrees.

31.2 When it disappeared:

- a. From true North \_\_\_\_\_ degrees.
- b. From horizon \_\_\_\_\_ degrees.

32. In the following sketch, imagine that you are at the point shown. Place an "A" on the curved line to show how high the object was above the horizon (skyline) when you *first* saw it. Place a "B" on the *same* curved line to show how high the object was above the horizon (skyline) when you *last* saw it.

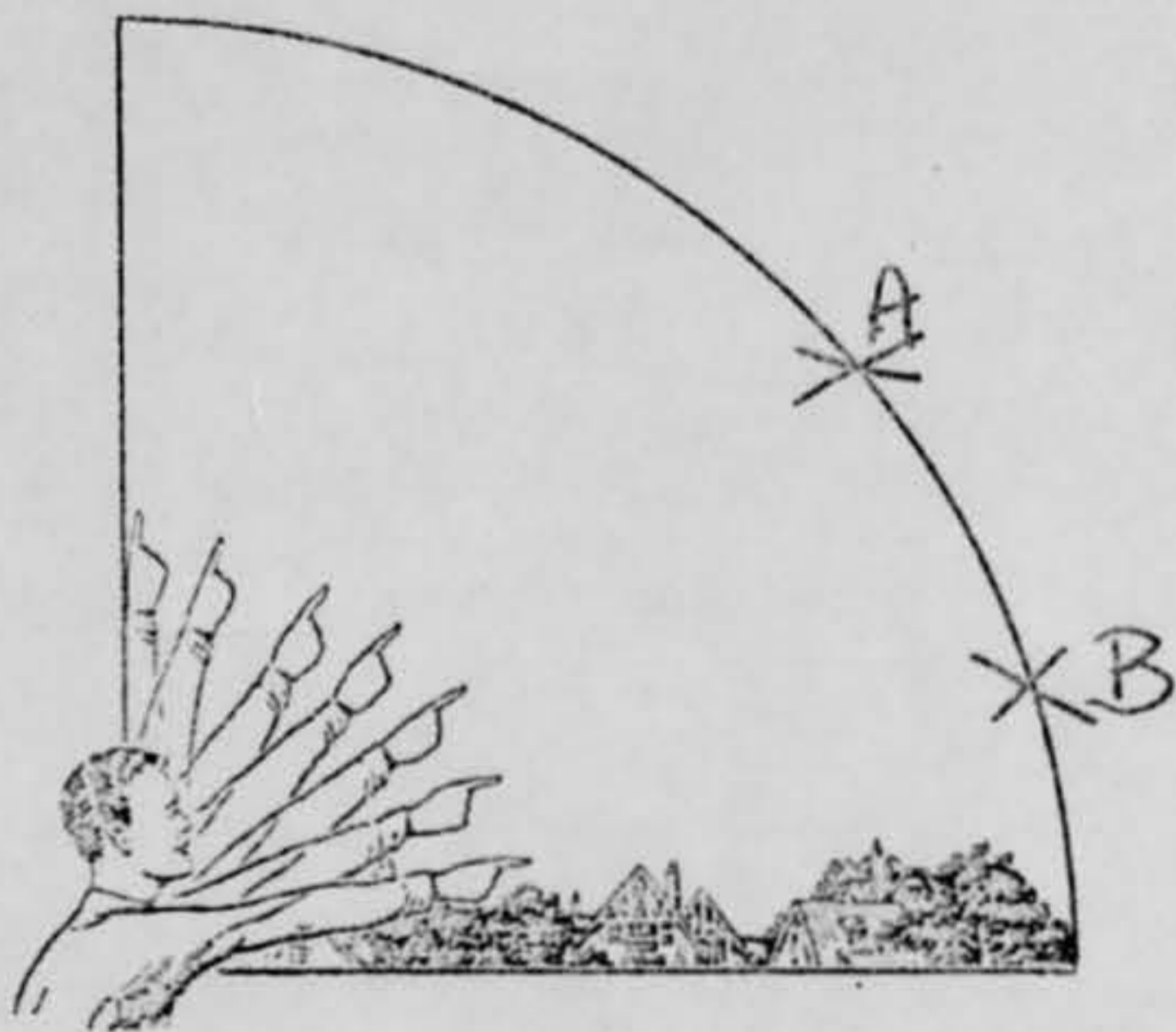

33. In the following larger sketch place an "A" at the position the object was when you *first* saw it, and a "B" at its position when you *last* saw it. Refer to smaller sketch as an example of how to complete the larger sketch.

